

Getting Started Guide



Tobii PCEye Explore

Overview

The Tobii eyegaze is a peripheral eye tracker that replaces the standard mouse, allowing you to navigate and control a desktop or laptop computer using only your eyes.

Unlike some other eyegaze devices, the pceye explore only allows you to move around the screen and left click with the mouse (as opposed to right click and drag and scroll functions that more advanced devices can offer).

Step by Step (2018 updated software)

To connect it to PC

1. The Eyegaze unit plugs into the PC by USB cable and sits on the front of the screen using a magnetic connector.
2. Ensure that the indentation on the magnetic strip is in-line with the midline of the Eyegaze unit
3. Open the GazePoint software by clicking on the red eye icon:



4. This will launch the gaze settings screen:

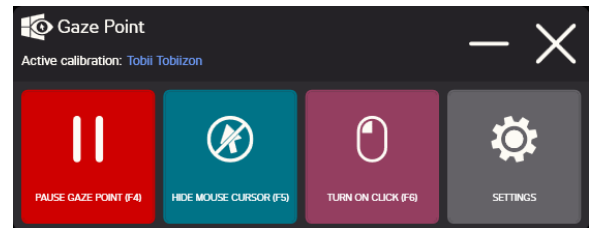

5. Make sure the first button “start Eyegaze” is activated and left click is activated.
6. To create a new user, calibrate adjust settings, click Settings and then Eyegaze

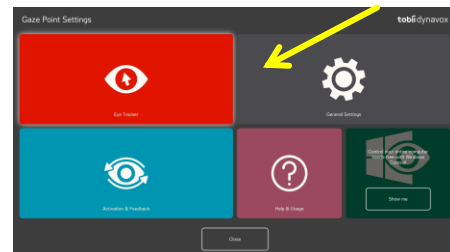

7. Click ‘Create new profile’ to do this
8. Ensure eyes are level and the arrow is in the green area of the bar

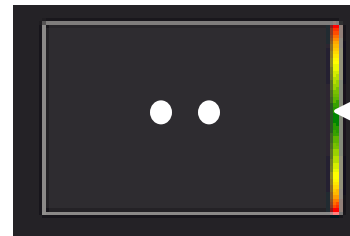

9. From this screen you can also change your calibration type, choose to track one or both eyes and customize your calibration. (see Bitesize training guide for further details)